

ON REGISTER

EASYTECH®

Stemless Primary Anatomical and Reverse

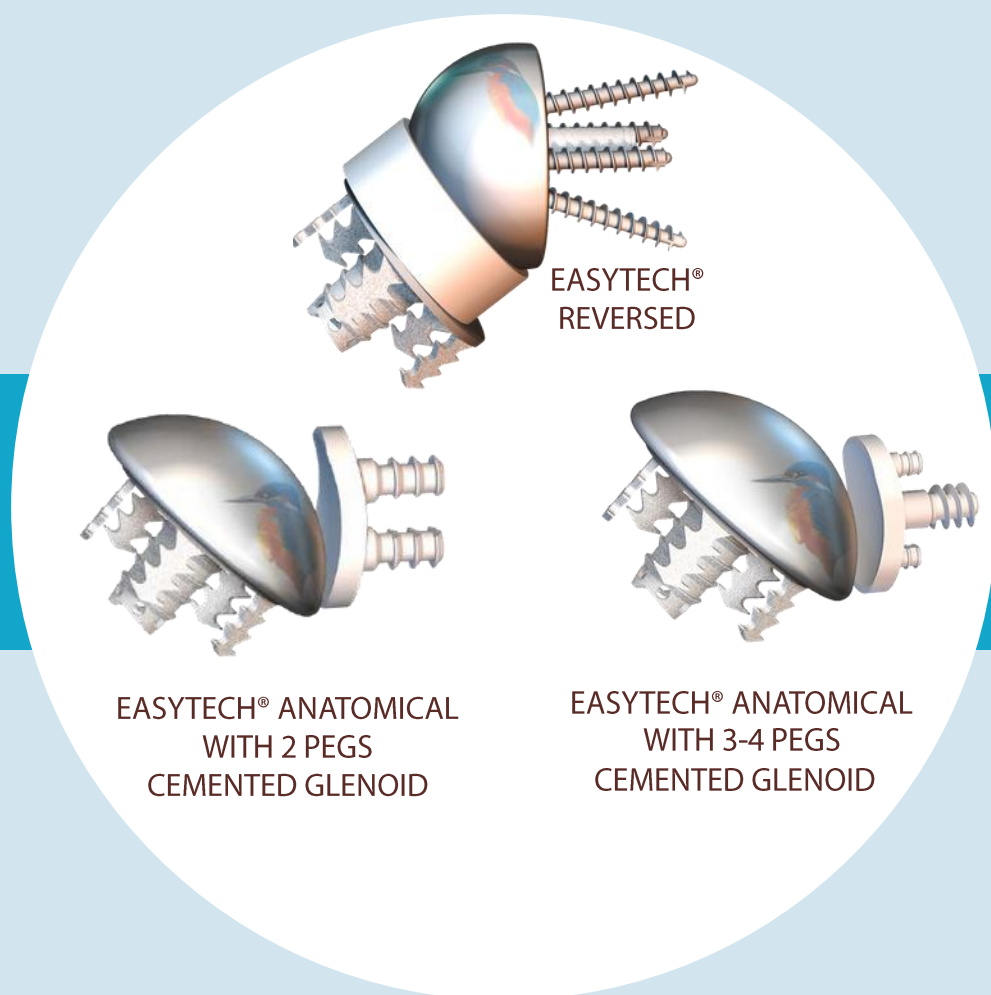

EASYTECH®
REVERSED

EASYTECH® ANATOMICAL
WITH 2 PEGS
CEMENTED GLENOID

EASYTECH® ANATOMICAL
WITH 3-4 PEGS
CEMENTED GLENOID

DEVICE DESCRIPTION

The EASYTECH® ANATOMICAL Shoulder Prosthesis consists of an anchor base, double taper connector or spacer (optional), humeral head, and glenoid component. Only the devices described in the surgical techniques are permitted for combined use in the U.S. market. Any combination of prosthetic components and/or instruments, other than those delivered by the manufacturer and/or distributor, is strictly prohibited.

The device can only be implanted after the surgeon has familiarized himself with the surgical technique. The surgery should be planned on the basis of a detailed evaluation of the patient's x-rays, since these provide important information on the choice of device (adaptation of dimensions to the individual case). Preoperative tracings and the surgical technique are available from the distributor or manufacturer.

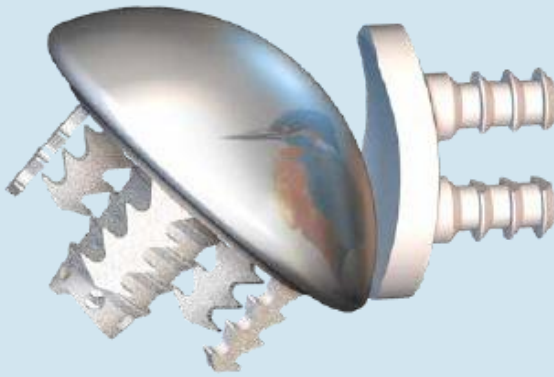

EASYTECH® ANATOMICAL
WITH 2 PEGS CEMENTED
GLENOID

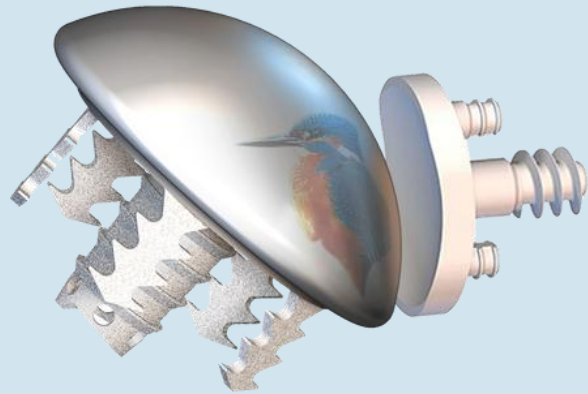

EASYTECH® ANATOMICAL
WITH 3-4 PEGS CEMENTED
GLENOID

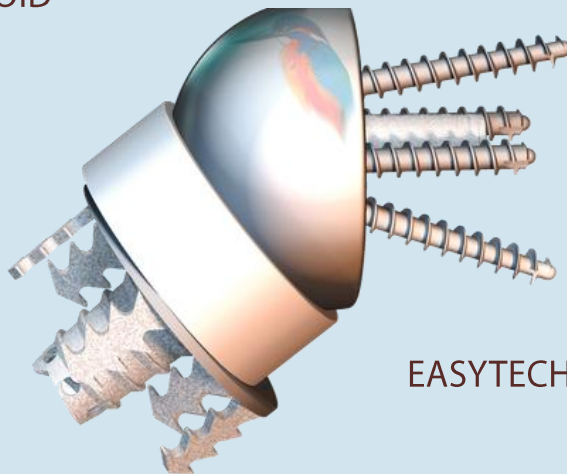

EASYTECH® REVERSED

DEVICE DESCRIPTION

ANCHOR BASE

Unique-to-Market peripheral fixation anchor base with bone sparing plasma-sprayed hydroxyapatite coating (HA) on Ti6Al4V ELI (conforming to ISO 5832-3).



EASYTECH ANCHOR BASE



ANCHOR BASE SIZES

- 30mm
- 34mm
- 38mm

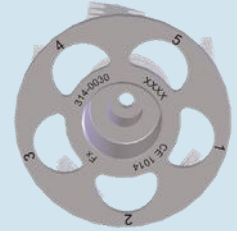

HUMERAL HEADS, TAPERS, AND SPACERS

The humeral heads are available in diameters of 39-50mm in centered and offset styles in CoCr and TiN.

The straight double taper connector and centered spacers allow the offset of the humeral head to be increased from +0 to +3 or +5 mm. The straight double taper connector and centered spacers are compatible with all sizes of anchor bases and humeral heads as listed in this technique.



CoCr
CONCENTRIC HEADS

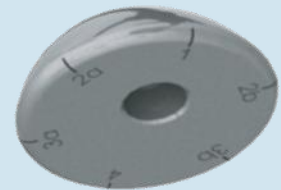

CoCr
ECCENTRIC HEADS

CONCENTRIC HEADS

- 39x14
- 43x16
- 46x17
- 50x19

DOUBLE TAPER



+3/+5MM
SPACER
TAPER

ECCENTRIC HEADS

- 39x15
- 43x17
- 46x18
- 50x20

DEVICE DESCRIPTION

RESURFACING GLENOID

Fits all anatomies Thermo-compressed UHMWPE inside a TA6V ELI shell, coated with Ti+HA. 2 extension pegs +6 and +10 mm for the possibility of longer anchoring.



2 PEGS GLENOID

The 2 pegs cemented glenoid component is available in sizes XS, S, M, and L. They feature two pegs for cemented fixation to the glenoid bone. It is manufactured from ultra-high molecular weight polyethylene (UHMWPE) conforming to ISO 5834-2. Each peg contains a radiopaque marker manufactured from tantalum conforming to ASTM F560.



3-4 PEGS GLENOID

The 3-4 pegs cemented glenoid component is available in sizes XS, S, M, and L. Sizes XS and S have three fixation pegs. Sizes M and L have four fixation pegs. It is manufactured from ultra-high molecular weight polyethylene (UHMWPE) conforming to ISO 5834-2. The central peg contains a radiopaque marker manufactured from tantalum conforming to ASTM F560.

